

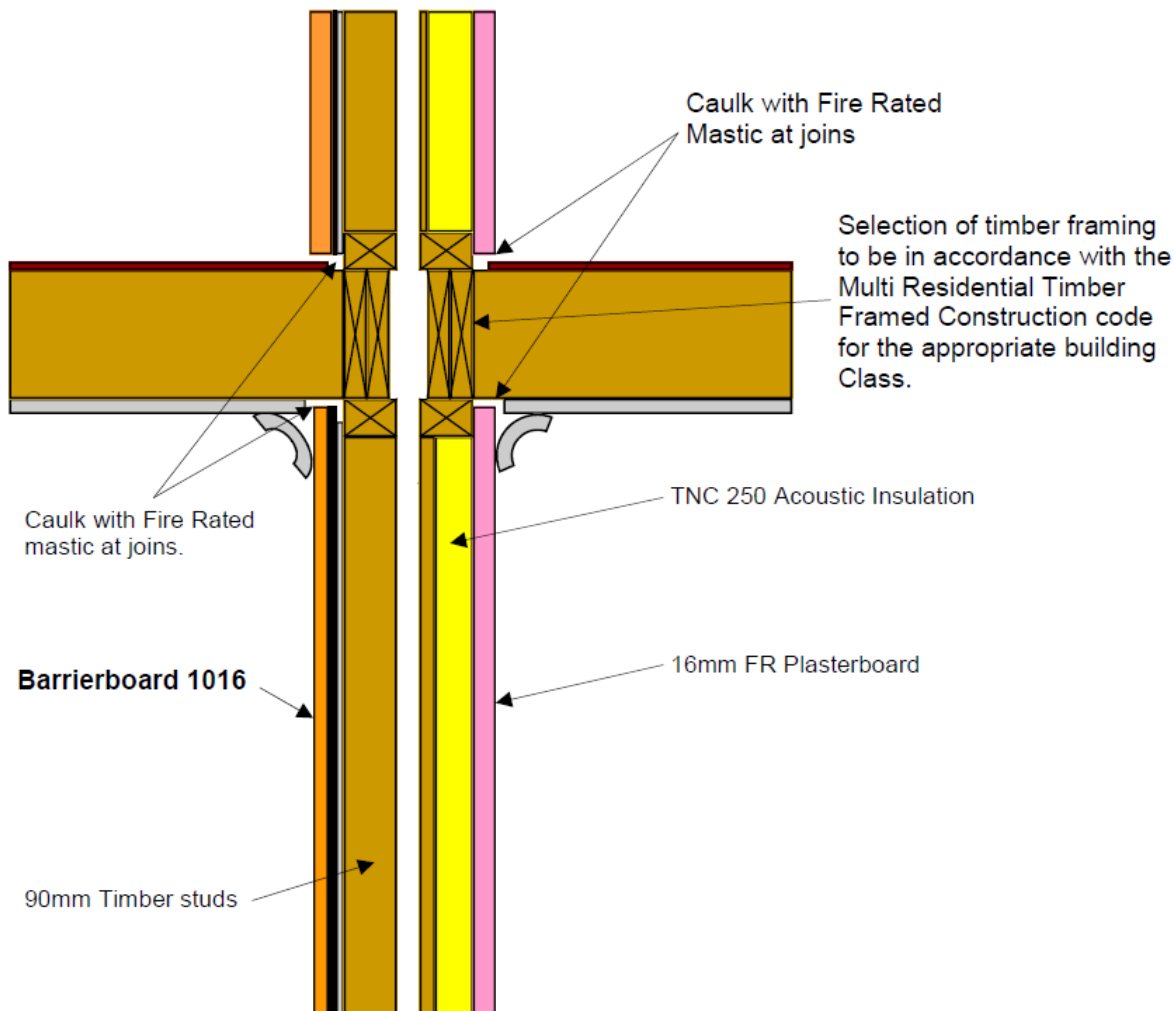

**For Multi storey Party or Common wall dwellings**



The information supplied in this data sheet is intended as a guide only. All structural details should be selected to comply with the provisions of the Australian Building Code.

**Construction Details (walls)**

Side A	<b>Barrierboard 1016</b>	<b>FRL rating</b>	<b>Wall thickness</b>	<b>Rw rating</b>
Battens	Metal Battens			
Insulation	TNC acoustic 250 polyester	60/60/60	248mm	60 Ctr-9
Frame	90mm Double Timber studs			
Side B	16mm Fire Rated plasterboard			

